

| REV | DESCRIPTION | DATE |
|-----|-------------|------|
| | | |
| | | |

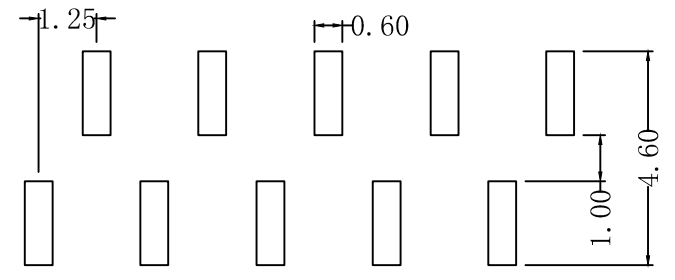
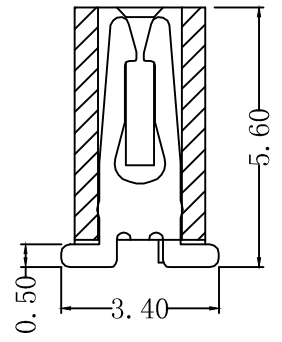
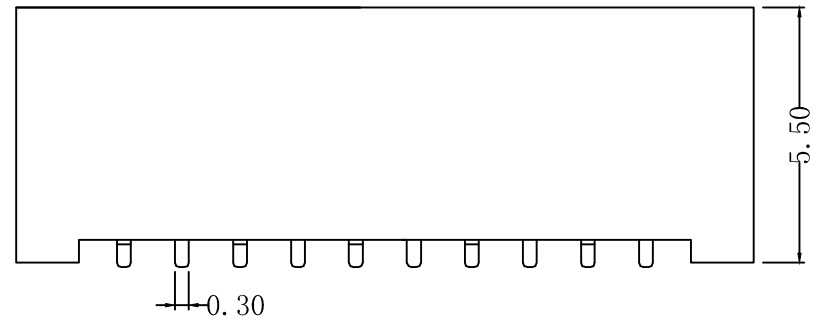
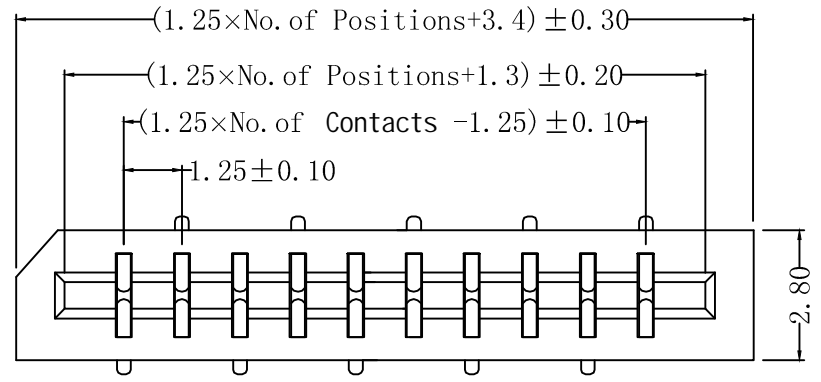

NOTE:

- MATERIAL
HOUSING: GLASS-REINFORCED THERMOPLASTIC UL 94V-0.
CONTACT: COPPER ALLOY.
PLATING: TIN PLATED OVER NICKEL.
- ELECTRICAL
CURRENT RATING: 1.0AMP.
DIELECTRIC WITHSTANDING VOLTAGE: 500V AC MIN.
INSULATION RESISTANCE: 500MΩ MIN.
CONTACT RESISTANCE: 30mΩ MAX.
- ENVIRONMENTAL
TEMPERATURE RANGE: -25°C TO 85°C.
- PART NO.
CNT-FPC125-XX-TSM-D1-550

RECOMMENDED PCB LAYOUT

| | | | | | | | | |
|----------------------|------------|--------------|-------------------|-----------|------------|----------|----------|---------------------------------------|
| CNT 肯耐特电子有限公司 | | | GENERAL TOLERANCE | | DRAWN | DATE | DWG. NO. | TITLE |
| | | | X.° ±5° | X. ±0.30 | 董道丽 | 20191011 | | |
| REV. 1.0 | UNIT mm | SCALE 1:1 | | .X° ±3° | .X ±0.38 | CHECK | DATE | PART. NO. CNT-FPC125-XX-TSM-D1-550 |
| | | | | .XX° ±2° | .XX ±0.25 | 王芳芳 | 20191011 | |
| | | | | .XXX° ±1° | .XXX ±0.15 | 王元中 | 20191011 | |

FPC/FFC 1.25 PITCH NON ZIF
TOP ENTRY DUAL CONTACT SMT
TYPE-SPECIAL PCB LAYOUT